

**Dimensions**

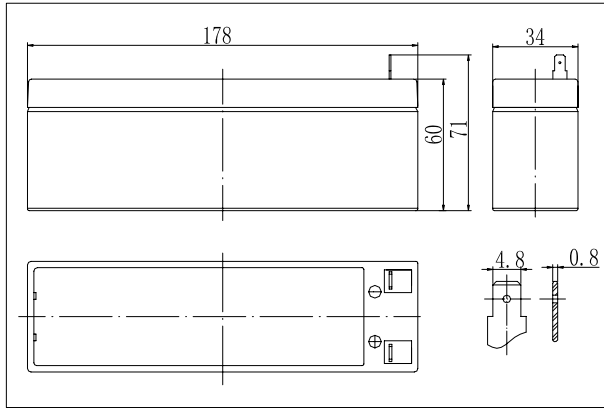

**Discharge Characteristics(25°C)**

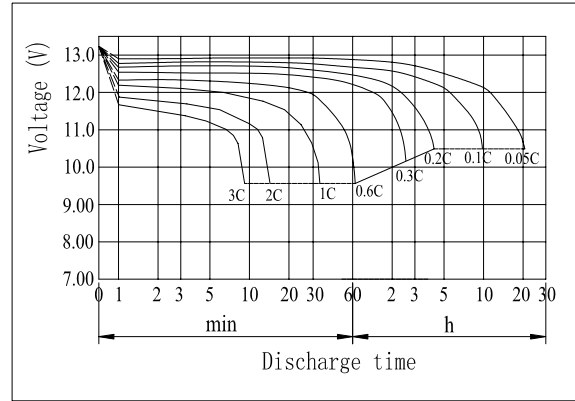

**Specifications**

Nominal Voltage	12 V	
Capacity(20HR, 25°C)	2.6Ah	
Dimension	Length	178mm +/- 1mm
	Width	34mm +/- 1mm
	Height	60mm +/- 1mm
	Total Height	71mm +/- 1mm
Approx. Weight	0.92kg	
Internal resistance (Fully charged, 25°C)	Approx. 45mΩ	
Capacity affected by temperature (20HR)	40°C	102%
	25°C	100%
	0°C	85%
	-15°C	65%
Self-discharge (25°C)	3 month	Remaining Capacity: 91%
	6 month	Remaining Capacity: 82%
	12 month	Remaining Capacity: 65%
Nominal temperature range	25°C±3°C	
Operation temperature range	-15°C - 50°C	
Float charging voltage(25°C)	13.60 to 13.80V	
Cyclic charging voltage(25°C)	14.50 to 14.90V	
Maximum charging current	1.04A	
Terminal material	Copper	
Maximum discharge current	39A(5 sec.)	

- Absorbent glass mat technology;
- Recognized by UL & CE;
- Flame retardant ABS container (UL94V-0/ 94V-2).

**Charging Characteristics(25°C)**

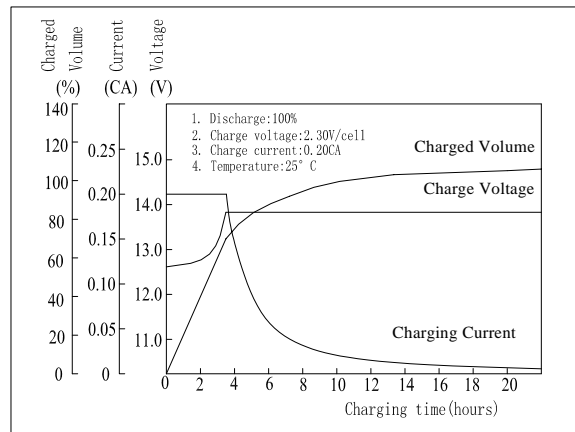

**Cycle Life(25°C)**

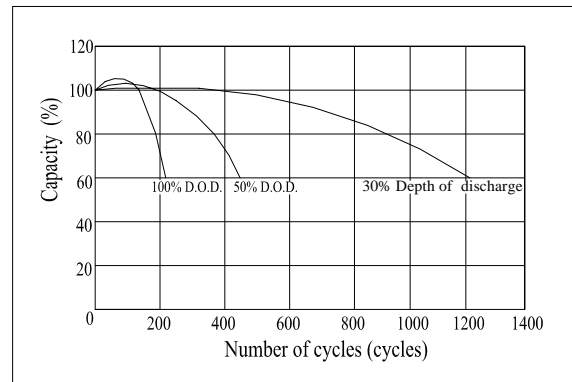

Note: Floating life at 25°C designed for 3 to 5 years.

**Constant Current Discharge Characteristics (A, 25°C)**

F.V/TIME	5min	10min	15min	30min	60min	3h	5h	10h	20h
9.60V	9.60	6.20	4.80	2.80	1.60	0.63	0.43	0.23	0.13
10.2V	9.12	5.89	4.61	2.69	1.54	0.62	0.42	0.23	0.13
10.8V	8.57	5.54	4.38	2.55	1.46	0.61	0.41	0.23	0.13

**Constant Power Discharge Characteristics (Watt, 25°C)**

F.V/TIME	5min	10min	15min	30min	60min	3h	5h	10h	20h
9.60V	107	69.9	54.7	32.1	18.5	7.48	5.09	2.80	1.58
10.2V	102	66.4	52.5	30.8	17.8	7.37	5.01	2.78	1.57
10.8V	95.7	62.5	49.9	29.3	16.9	7.22	4.91	2.78	1.56