

Dimensions

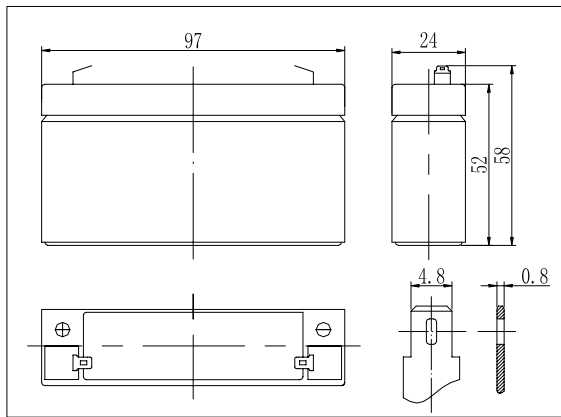

Discharge Characteristics(25°C)

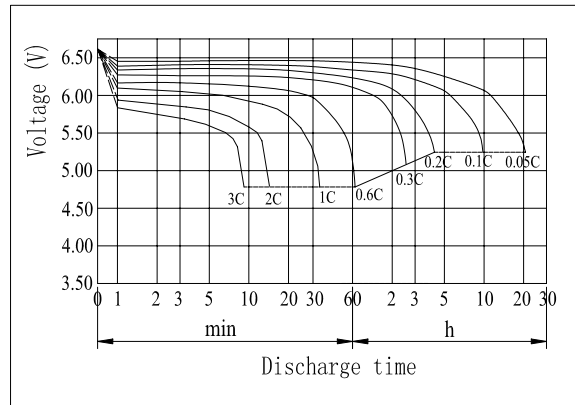

Specifications

Nominal Voltage		6 V
Capacity(20HR, 25°C)		1.3 Ah
Dimension	Length	97mm +/- 1mm
	Width	24mm +/- 1mm
	Height	52mm +/- 1mm
	Total Height	58mm +/- 1mm
Approx. Weight		0.31kg
Internal resistance (Fully charged, 25°C)		Approx. 50mΩ
Capacity affected by temperature (20HR)	40°C	102%
	25°C	100%
	0°C	85%
	-15°C	65%
Self-discharge (25°C)	3 month	Remaining Capacity: 91%
	6 month	Remaining Capacity: 82%
	12 month	Remaining Capacity: 65%
Nominal operating temperature		25°C±3°C
Operating temperature range		-15°C-50°C
Float charging voltage(25°C)		6.80 to 6.90V
Cyclic charging voltage(25°C)		7.25 to 7.45V
Maximum charging current		0.48A
Terminal material		Copper
Maximum discharge current		18A(5 sec.)

Charging Characteristics(25°C)

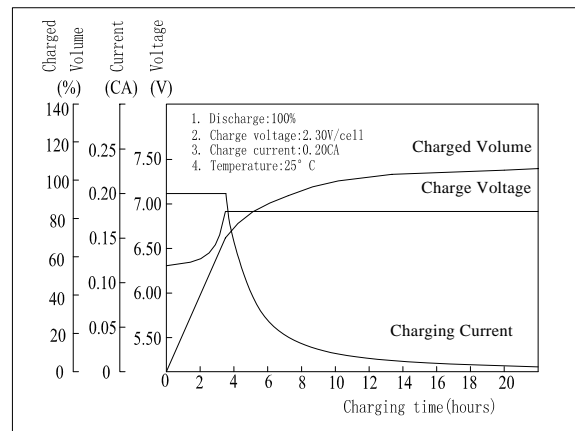

Cycle Life(25°C)

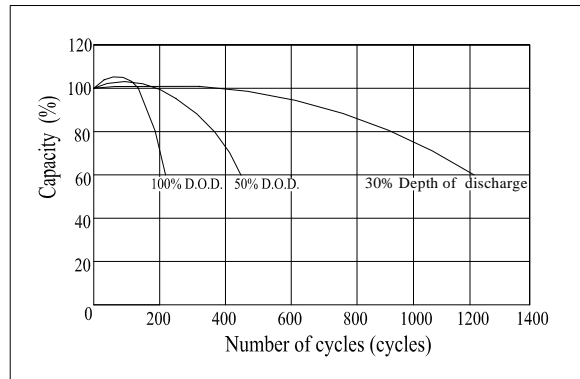

- Absorbent glass mat technology;
- Recognized by UL & CE;
- Flame retardant ABS container (UL94V-0/ 94V-2).

Note: Floating life at 25°C designed for 3 to 5 years.

Constant Current Discharge Characteristics (A, 25°C)

F.V/TIME	5min	10min	15min	30min	60min	3h	5h	10h	20h
4.80V	5.00	3.20	2.50	1.45	0.82	0.33	0.22	0.12	0.066
5.10V	4.75	3.04	2.40	1.39	0.79	0.33	0.22	0.12	0.065
5.40V	4.47	2.86	2.28	1.32	0.75	0.32	0.21	0.12	0.065

Constant Power Discharge Characteristics (Watt, 25°C)

F.V/TIME	5min	10min	15min	30min	60min	3h	5h	10h	20h
4.80V	27.90	18.05	14.25	8.30	4.75	1.96	1.315	0.72	0.40
5.10V	26.50	17.15	13.70	7.95	4.575	1.96	1.315	0.72	0.39
5.40V	24.95	16.15	13.00	7.55	4.345	1.90	1.255	0.72	0.39